

MECHANICAL TEST PLUG

» 882 SERIES

HandTite™

SPECIFICATION

Sioux Chief 882 series HandTite mechanical test plug shall be used where necessary in drainage systems. Test plug shall be corrosion resistant and easy to install. Test plug shall be reusable and approved for installation in underground or buried applications.

MATERIALS

Rigid components: Nylon #6

Expansion gasket: Polyisoprene

DIMENSIONS

	882-95	882-96	882-98
A: Expansion diameter	4.75" – 5.75"	5.75" – 6.75"	7.875" – 8.875"
B: Bottom plate diameter	4.81"	5.75"	7.66"
C: Top plate diameter	5.87"	6.51"	8.55"
D: Handle width	5.37"	5.37"	7.56"
E: Stem height	5.20"	5.20"	6.71"

ITEM # SUBMITTED	_____
JOB NAME	_____
LOCATION	_____
ENGINEER	_____
CONTRACTOR	_____
PO#	_____ TAG _____



882-96

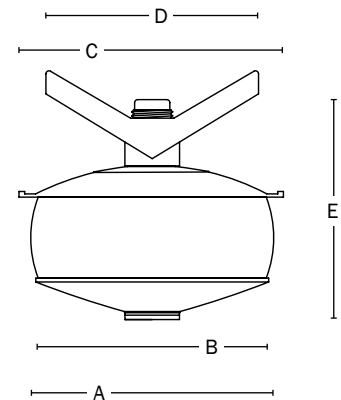

Create Item Number

882-A

e.g. **882-96:** HandTite mechanical test plug for 5.75" - 6.75" openings

PLUG SIZE A

95 = 4.75" - 5.75" model

96 = 5.75" - 6.75" model

98 = 7.875" - 8.875" model